

## LOCATION MAP



MO :98797 03335  
98797 03336  
Web : Royalpalm.in

Office Address :  
Royal Group, Plot No. 170 , Patel Avenue , GF -1,  
Sector - 1/A Near Tvs Showrooms , Gandhidham ( Kutch )

Site Address : ROYAL PALM  
Nr. Mathak Shinay - Mundra Highway

# Royal palm

## Nurture with Nature

Weekend villa /plots





REJOICE

A fantastic club with extensive range of lifestyle amenities that lets you enjoy and cherish each moment that you spend here.

There are various sport amenities that let you play till your heart is contented. Feel the vivacious excitement of sports and have a smashing time.



REVIVE

This majestic project lets you forget about all the stress and worries of day to day life. Let go of the boredom and say hello to utmost relaxation.



RELAX

Life is better at *Royal Palm*

**Royal Palm** is a fabulous opportunity to live the life of your dreams.

These weekend villas are created to fulfil your every wish, desire and aspiration.

It's not just a weekend home,  
it's going to be the most beautiful part of your life.





*Welcome to Wonderment*

Royal  
palm



MAIN ENTRY | SECURITY CABIN | CCTV SURVEILLANCE





*En extra vegant entrance*

Royal  
palm



CLUB HOUSE | COMMON SITTING | RECEPTION AREA





SWIMMING POOL | SPLASH POOL | CABANAS | RAIN SHOWER



*The Club*

Royal  
palm





CHILDREN PLAY AREA



LAWN TENNIS



EVENT LAWN



## YOUR WEEKENDS JUST GOT MORE EXCITING

Don't let the child in you get old. Play and enjoy your favourite sport with family and friends. And for your little ones there's an exclusive children play area.



BOX CRICKET



**A Privileged Life That Your  
Family Truly Deserves  
In Town**

*Royal*  
palm

PARTY LAWN



GYMNASIUM



INDOOR GAMES



THEATER



CARD ROOM



TODDLER ROOM





CLUB HOUSE

GROUND FLOOR PLAN

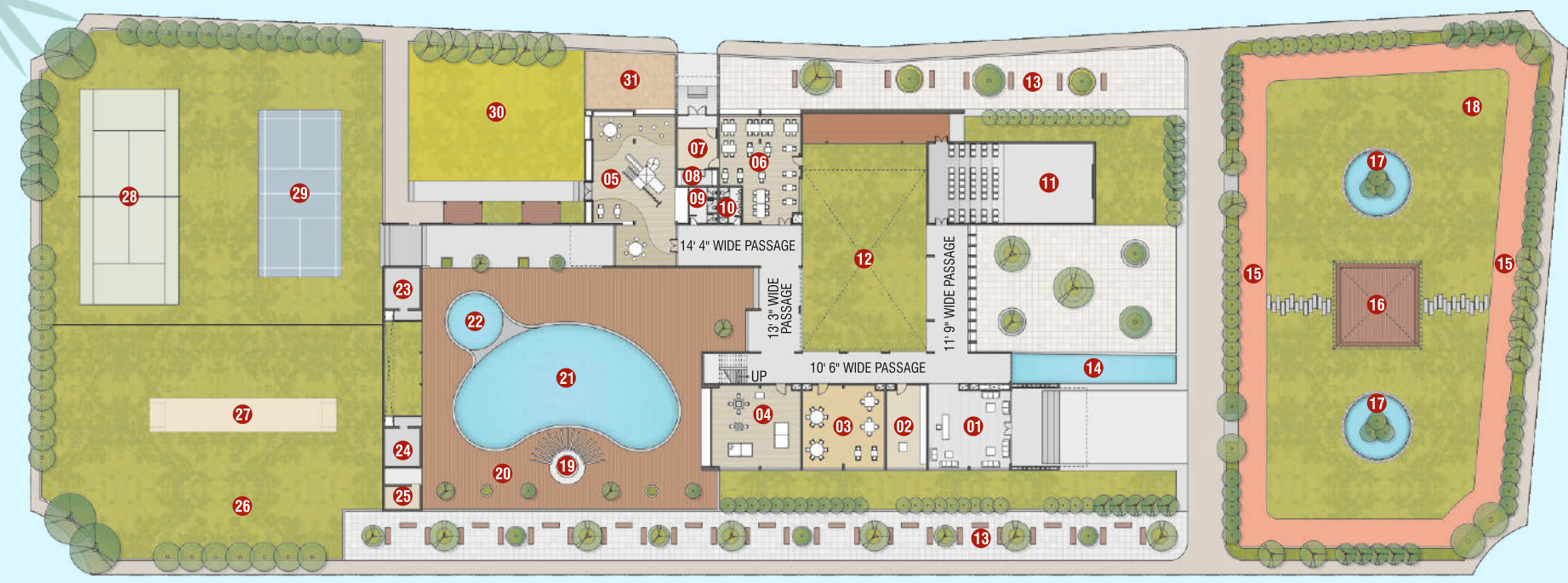

FIRST FLOOR PLAN

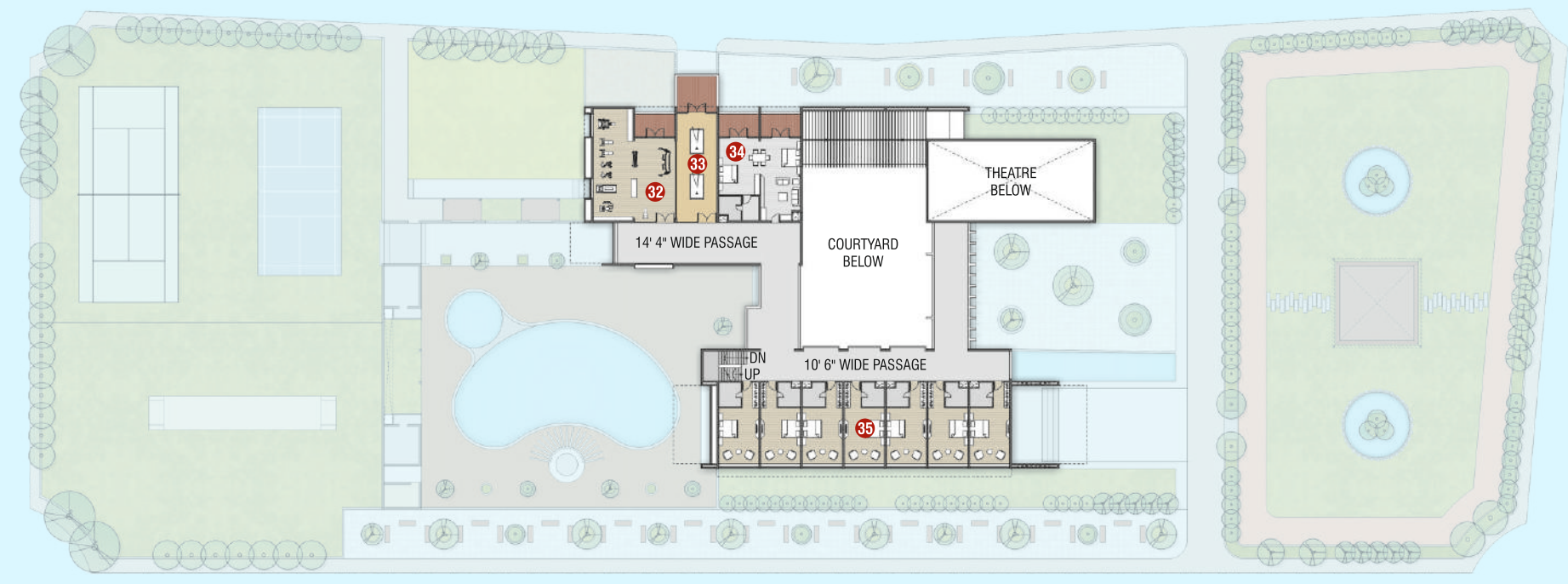

LEGENDS

	01 Reception Area		02 Library		03 Board Games		04 Indoor Games		05 Indoor Kids Play Area
	06 Restaurant		07 Kitchen		08 Wash Area		09 Ladies Toilet		10 Gents Toilet
	11 Theater / Discotheque		12 Event Lawn		13 Common Sitting		14 Water Body		15 Jogging Track
	16 Gazebo		17 Lily Pond		18 Trampoline		19 Rain Shower		20 Cabanas
	21 Swimming Pool		22 Splash Pool		23 Ladies Changing Room		24 Gents Changing Room		25 Store Room
	26 Outdoor Gym		27 Box Cricket		28 Lawn Tennis		29 Volley Ball		30 Outdoor Children Play Area (With Rides)
	31 Sand Pit		32 Gym		33 Pool Table		34 Suite Room		35 Guest Room





A CHARMING VILLA THAT PROMISES  
A BLISSFUL LIVING EXPERIENCE



Everything you need to live a cheerful life is here.  
Elegant architecture, spacious rooms, peaceful greenery and much more.



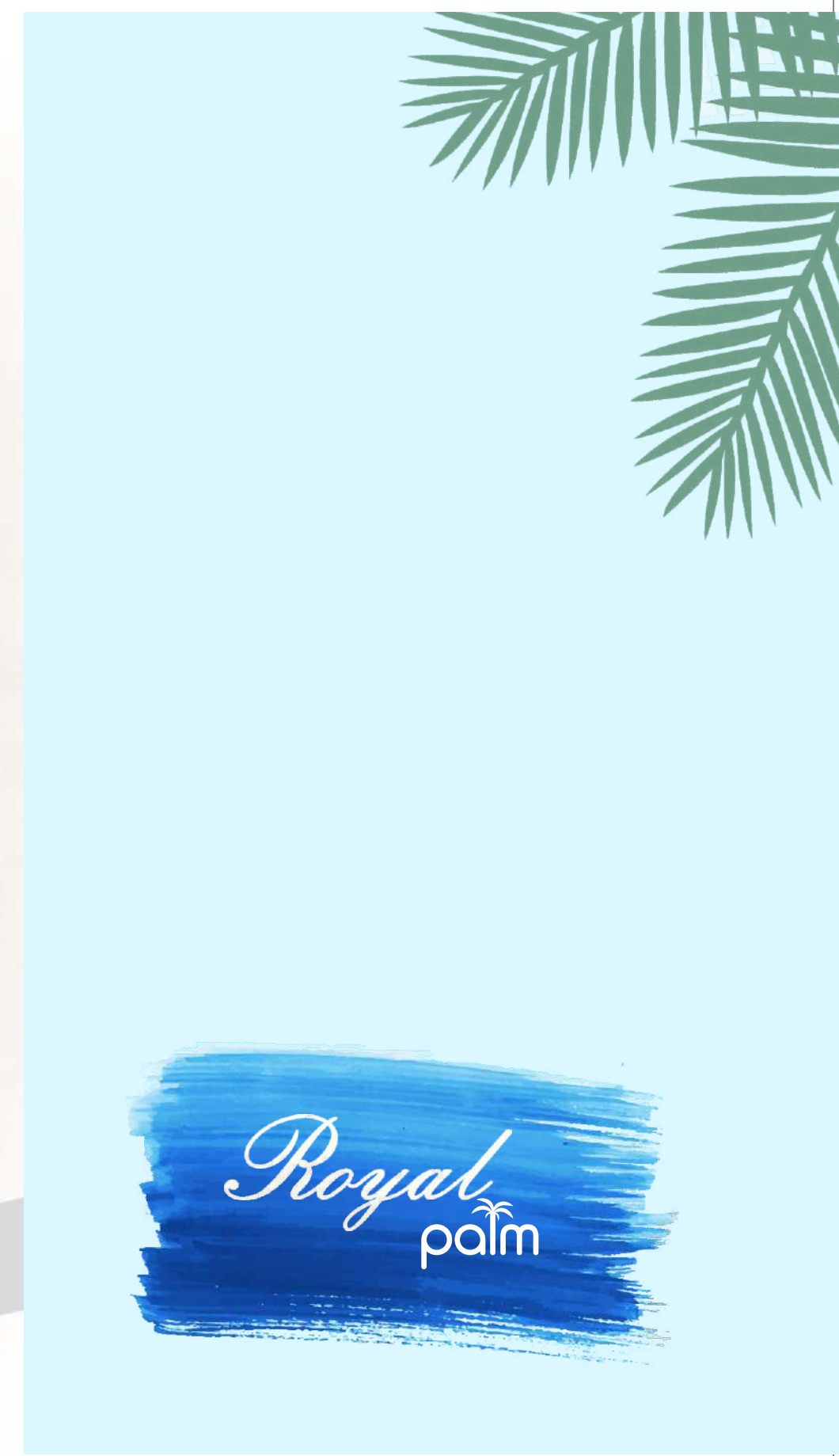
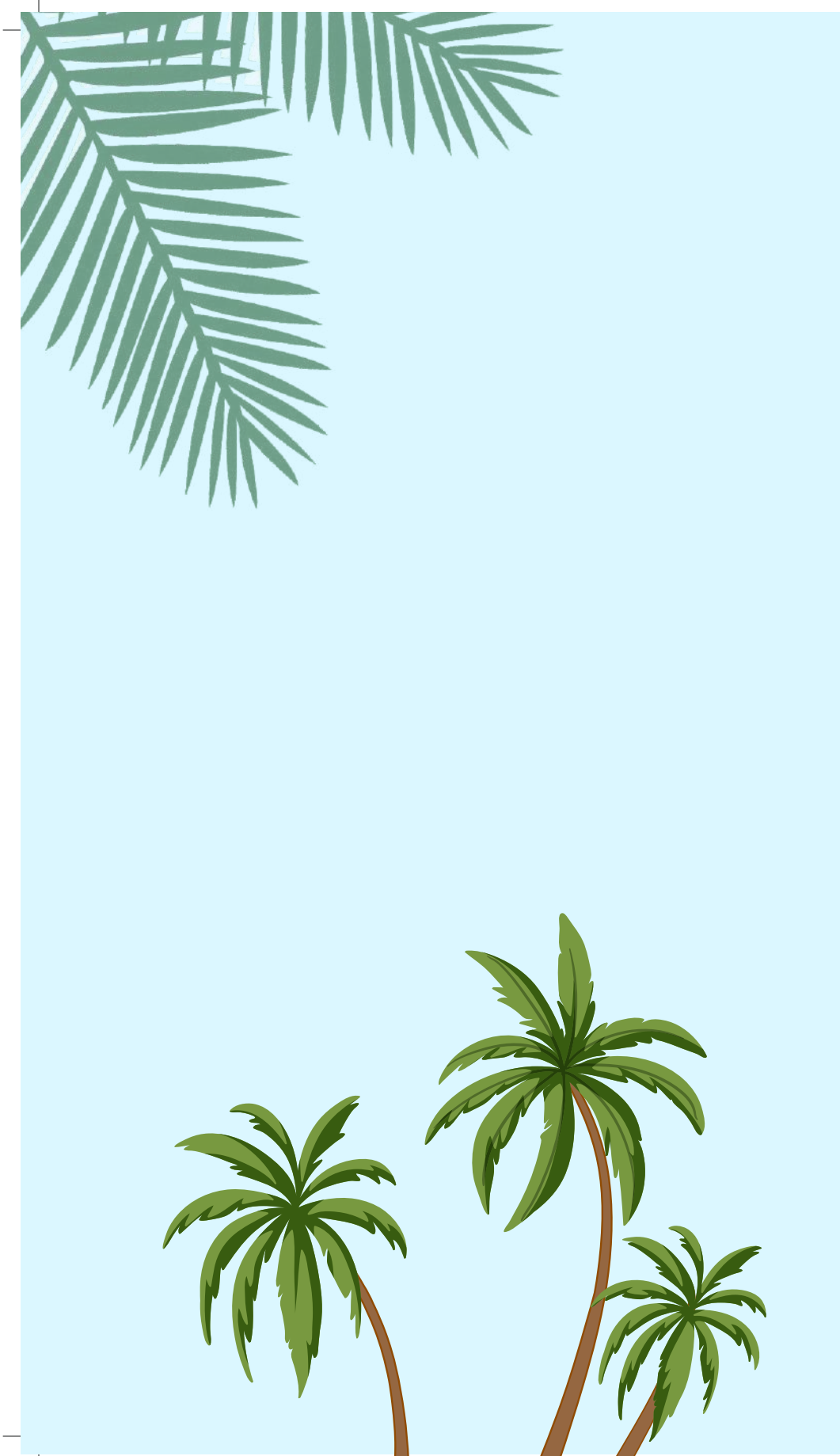





## THE KINGDOM OF FINEST LUXURIES AWAITS YOU

Why go anywhere else, when you have such  
a modern-day paradise to enjoy.

You are bound to cherish the beautiful moments you  
spend here with your friends and family.







3 BHK  
UNIT PLAN

LEGEND

01	OTTA	30' 3" X 9' 6"
02	LIVING	18' 0" X 15' 0"
03	PANTRY	11' 9" X 8' 3"
04	WASH	6' 0" X 6' 6"
05	BEDROOM	13' 9" X 12' 6"
06	TOILET	5' 0" X 8' 9"
07	BEDROOM	13' 0" X 14' 0"
08	TOILET	5' 0" X 9' 3"
09	BEDROOM	13' 0" X 17' 0"
10	TOILET	13' 0" X 6' 6"
11	PARKING	14' 0" X 33' 6"
12	FLOWER BED	8' 0" X 15' 0"
13	FRONT GARDEN	43' 6" X 19' 11"
14	BACK GARDEN	29' 3" X 27' 6"





## 2 BHK UNIT PLAN

### LEGEND

01	OTTA	27' 9" X 9' 6"
02	LIVING	15' 0" X 15' 0"
03	PANTRY	11' 9" X 8' 3"
04	WASH	6' 0" X 6' 6"
05	BEDROOM	12' 0" X 14' 0"
06	TOILET	5' 0" X 8' 3"
07	BEDROOM	12' 0" X 15' 0"
08	TOILET	12' 0" X 5' 6"
09	PARKING	13' 0" X 33' 6"
10	FLOWER BED	8' 6" X 15' 0"
11	FRONT GARDEN	41' 6" X 19' 6"
12	BACK GARDEN	55' 0" X 15' 10"

